

THETFORD



N3000 series

User Manual

Australian market

INDEX

	LED control panel	Touchscreen
1 Introduction	5	12
2 Use safely	5	12
3 Switch on refrigerator	6	13
4 Selecting source	6	13
5 Selecting cooling level	7	14
6 Anti-condensation	7	14
7 Use of refrigerator compartment	7	14
8 Use of freezer compartment	8	15
9 While driving	8	15
10 Cleaning	8	15
11 Switch off refrigerator	9	15
12 Defrosting	9	15
13 Storage	9	16
14 Disposal	9	16
15 Questions?	9	16
16 Warranty	10	17
For guarantee/service	18	18

INSTRUCTIONS FOR USE

N3185E+ with LED control panel

Gross volume: 177L

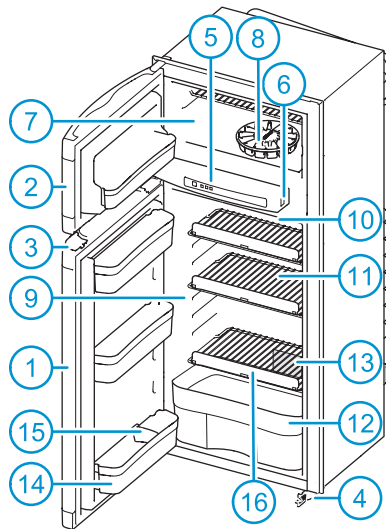

LED-control panel

(N3185A with touchscreen → p. 11)

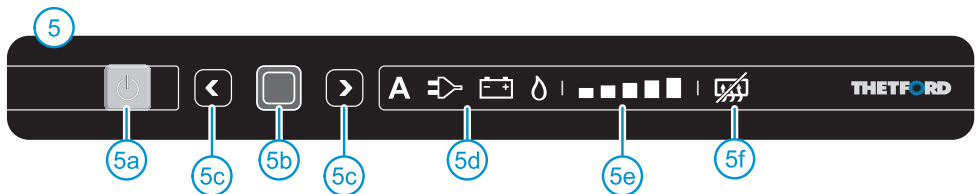

Main parts

1 Refrigerator door • 2 Freezer door • 3 Door lock • 4 Security lock • 5 Control panel LED+ • 5a On/off switch • 5b Confirmation button • 5c Arrow buttons • 5d Sources • 5e Cooling level indicators • 5f 'Anti-condensation' (only for model N3185) • 6 Switch for fans • 7 Freezer compartment • 8 Ice cube tray • 9 Refrigerator compartment • 10 Cooling fins • 11 Storage shelf • 12 Vegetable bin • 13 Serial label • 14 Door bin • 15 Bottle retainer • 16 Shelf food retainer

1 Introduction

This Thetford appliance is specially developed for caravans or motorhomes. It is user-friendly, meets high quality standards and gives you every possible convenience during holidays and short trips. We advise you to read the manual before using the appliance. Not all sections of this manual are relevant for all appliances. Make sure you completely read the parts of the manual that are relevant for your appliance. Keep this manual in a safe place for future reference.

For the latest version of the manual please visit www.thetford.com.au

Symbols used



Caution (possible risk of injury or product damage).



Attention. Important information.

2 Use safely

For correct and safe use of this refrigerator, you need to observe several precautions and general recommendations. If these instructions have not been followed, warranty claims will not be accepted.



What to do if you smell Liquefied Petroleum gas (LP gas): Directly close the valve of the LP gas bottle, extinguish any naked flames, do not switch on any electrical devices or lighting, open the windows and leave the room. Then contact the Customer Service Department in your country or holiday location.



What to do if you smell a pungent odour from the cooling system: Switch off the refrigerator, extinguish any naked flames, provide sufficient ventilation through vents, windows and doors. Then contact the Customer Service Department in your country or holiday location.



This appliance can be used by children aged from 8 years and above and persons with reduced physical, sensory or mental capabilities or lack of experience and knowledge if they have been given supervision or instruction concerning use of the appliance in a safe way and understand the hazards involved.



Do not allow children to play with or hide in the appliance. Children can become trapped and possibly suffocate. Do not allow children to clean or perform maintenance on the appliance without supervision.



The storage of flammable materials behind or around the refrigerator creates a fire hazard. Do not use the area behind the refrigerator to store anything, especially flammable materials (gasoline, cleaning supplies, etc).



Do not spray liquids near electrical outlets, connections or the refrigerator components. Many liquids are electrically conductive and can cause a shock hazard, electrical shorts and in some cases fire.



At regular intervals, make sure that the refrigerator flue, the burner, the vent areas and the ventilation air pathway between the vents are completely free from any flammable material or blockage. After a period of storage, it is especially important to check these areas for any flammable material or blockage caused by animals.



Do not store or use gasoline or other flammable vapors and liquid in the vicinity of this or any other appliance.

Maintenance

- Make sure that installation, electrical connection, maintenance and periodical inspection of the LP gas system will be done by a qualified technical person, according to Thetford's instructions (www.thetford.com.au) and local safety rules;
- Never open or damage the cooling system at the back of your refrigerator. The cooling system is pressurised and contains substances that can be harmful to your health;
- Never attempt to repair parts of the LP gas system, the LP gas flue or electrical components by yourself. The repairs may only be done by a qualified technician. Please contact the Customer Service Department for further support and addresses;
- Before carrying out any kind of maintenance or cleaning on your refrigerator switch off your refrigerator and disconnect both the AC and DC power sources;
- Never expose the refrigerator to rain;
- The LP gas burner must be inspected and cleaned at least once a year.

Use of LP gas

- The refrigerator is designed to run on LP gas. It does not run on natural gas or coal gas;
- Only use gas which is mentioned on the serial label inside the refrigerator;
- Make sure the type and position of the LP gas bottle meets the latest technical regulations;
- Change the LP gas bottle in open air and out of reach of any possible source of ignition;
- Never obstruct the ventilation openings in the LP gas bottle storage location;
- Keep flammable material away from the refrigerator;
- Do not use LP gas to power your refrigerator in the vicinity of petrol stations.

Food

- Respect the expiry date printed on the packaging of food;
- Defrosting, cleaning or maintenance of the refrigerator can shorten the preservability of food.

Medications

As the constant regulation of temperature can not be guaranteed, the refrigerator might not be suitable for proper storage of medications. Refer to the instructions included with the medications.

3 Switch on refrigerator



To switch on the refrigerator, push the on/off switch and hold it for 1 second, as illustrated. A light in the on/off switch will turn green and the

selected settings are shown on the display.

After 10 seconds the settings will dim. The green light indicates the refrigerator is still in function.

To check the settings push the on/off switch. The last selected settings will light up.



To secure optimal performance, level your vehicle before operating the refrigerator.



For optimal performance, switch on the refrigerator 8 hours before placing food.



We advise to clean the inside of the refrigerator properly before using your refrigerator.

4 Selecting source

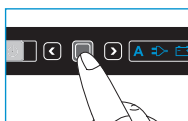

After switching on the refrigerator, push the confirmation button and hold it for 2 seconds. The symbols for the sources light up and start to blink.

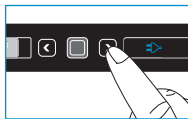

Choose the desired source by pushing the arrow buttons.



Confirm your choice with the confirmation button.

Sources



Auto

The refrigerator automatically selects the best source available (in order: mains, battery, LP gas)



240V

The refrigerator is powered from the mains.



12V

The refrigerator is powered from the battery of your vehicle.



LP gas

The refrigerator is powered from the gas connection of a LP gas bottle.

Always use the gas connection or mains voltage to start up and cool. Operating on 12V is only effective while the engine of the vehicle is running.

Auto

If you set the refrigerator on the automatic source selection, the control panel will show two source symbols; the A and the best source available.

It is possible to override the automatic source selection by selecting one of the energy sources manually.

240V

Make sure 240V AC is available when selecting this energy source.

12V

Make sure 12V DC is available when selecting this energy source.

The performance of the refrigerator, when operating on 12V, is dependent on the thickness and length of the wiring and the overall installation of the vehicle.



In case the refrigerator is installed in a caravan, the refrigerator needs a D+ signal (engine running) from the towing vehicle to operate in DC mode while travelling.

LP gas

Make sure the LP gas bottle valve is opened, when selecting this energy source. If the refrigerator is powered by a gas connection, make sure the control panel is powered from the battery.

When selecting LP gas, the flame should be ignited within 30 seconds. If the system fails, restart the refrigerator and select the LP gas source again.

For safety reasons it is not possible to ignite the flame within 15 minutes after driving.

From about 1000 m above sea level problems of a physical nature can occur when lighting the LP gas. This does not mean that the refrigerator is not working properly.

5 Selecting cooling level

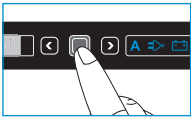

After switching on the refrigerator, push the confirmation button and hold it for 2 seconds.

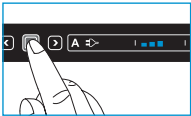

The symbols for the sources start to blink. Push the confirmation button again.

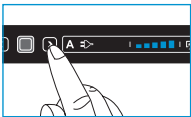

The cooling level indicators start to blink. Use the arrow button to choose the desired cooling level.



Confirm your choice with the confirmation button.

Lowest cooling level  Highest cooling level



The refrigerator has climate class T. We advise to set the refrigerator on cooling level 3, with an ambient temperature between 15°C and 25°C. A higher temperature needs a higher cooling level, a lower temperature a lower level.

Fans

There are two fans at the rear of the refrigerator to improve the cooling performance of your refrigerator in high temperatures. It helps to detract the warm air quicker to the vents.

To switch on 1 fan (at ambient temperatures

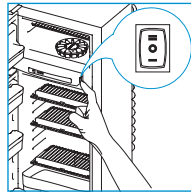

above 32°C), push the ventilator switch to '1'. For activating 2 fans (at ambient temperatures above 38°C), switch to '2', as illustrated. To switch off the fans, push the fan switch back to '0'.

6 Anti-condensation



To prevent the control panel from condensation, the anti-condensation function is automatically switched on. Only switch off this function when little energy is present.

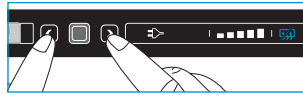

Push both arrow buttons together at once and hold

them for 2 seconds, as illustrated. The symbol 'anti-condensation off' will light up on the control panel. To switch on the function again, push both arrow buttons for 2 seconds once more.

7 Use of refrigerator compartment

You can organise your refrigerator as desired by moving the storage shelves and door bins in height.



Make sure the door can still be closed after reorganising shelves and bins.

Moving storage shelves

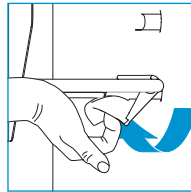

First remove the screw below the plastic clamp of the storage shelf. Then turn the plastic clamp upwards, as illustrated. Lift that side a bit, and move the storage shelf to the desired position.

First place the side of the storage shelf without the plastic clamp in the refrigerator wall, then the other side in the corresponding groove. Turn the plastic clamp downwards and replace the screw underneath. Your storage shelf is secured again.

Moving door bins

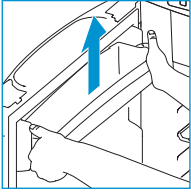

Push a door bin out of the locking with both hands, as illustrated. Place this door bin back in the desired position and push it back on the locking. The door bin is secured again.

Organising food

After a minimum of 8 hours of cooling, the food can be placed in the refrigerator. To preserve an optimal performance of the refrigerator, do not completely cover the cooling fins with food. Make sure air can still circulate around the fins.



To prevent your refrigerator from ice-formation, always cover liquid products, let warm products cool down before placing them in the refrigerator and don't open the door any longer than necessary.



To reduce the cooling time, store only pre-cooled food in the refrigerator.



To prevent the food from drying out or your refrigerator from odours, store food separately in closed boxes.

8 Use of freezer compartment

You can use the freezer compartment to keep food frozen or to make ice cubes with the included Thetford ice cube tray.



Never keep carbonated liquids in the freezer compartment.



If the refrigerator has to perform for a longer period in internal vehicle temperature below 10°C, a constant regulation of temperature in the freezer compartment can't be guaranteed. The temperature can increase and the food may defrost in the freezer compartment.

Making ice-cubes

Fill the ice-cube tray with water and put the tray in the freezer compartment. Make sure you only use drinking water.



Never eat ice-cubes or popsicles directly out of the freezer compartment. This can cause burns.



To speed up the process, make ice-cubes at night, when the refrigerator has more capacity. Place the ice-cube tray in an empty freezer on the bottom and the back.

9 While driving

Do not operate your refrigerator on LP gas while driving. This can reduce performance, cause an unstable flame or extinguish the flame.

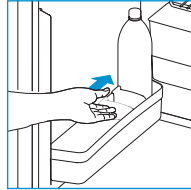

Make sure all products in your refrigerator can't move. Secure the bottles in the door with the bottle retainer and secure all food on the storage shelves with the shelf food retainers.

Door lock

When you close and press the door of the refrigerator, the door locks automatically. While driving this door lock also secures the door.

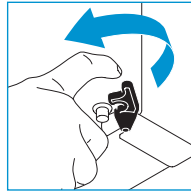

The refrigerator has an extra security lock on the bottom of the refrigerator. To be sure the door will not open while driving, push the black security lock over the pin on the door.

10 Cleaning

It is important to regularly clean the refrigerator for optimal performance. Clean the inside with a soft cloth and a mild household cleaner. Use a wet, soft cloth for the outside of the refrigerator. Make sure the vents on the outside of the vehicle are always dust-tight.



Never clean your refrigerator with soap or aggressive, caustic or soda-based cleaning agents.



The loose parts of the refrigerator are not suitable for the dishwasher.



Water through the vents may damage your refrigerator.

11 Switch off refrigerator

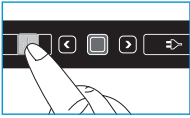

Before defrosting the refrigerator or storing your vehicle, switch off the refrigerator. Push the on/off switch, as illustrated,

and hold it for 2 seconds to switch off the refrigerator. All lights will go out.

12 Defrosting

A layer of ice on the cooling fins will decrease the cooling capacity and durability of your refrigerator. Therefore your refrigerator is provided with an automatic defrost system, which prevents ice formation.

Every 49 hours the refrigerator can start a defrost cycle. The defrost cycle is started if the fin temperature is measured below 1°C and ends when the fin temperature rises above 3°C or when 30 minutes have passed, whatever comes first.

Despite this system, it is also possible to manually defrost your refrigerator on occasion. Remove all food, wrap it tightly in newspaper and put it in a cold place or in an insulated bag. Then open the doors. Put dry towels in the refrigerator to catch the remaining water. When the refrigerator is defrosted, thoroughly dry the inside.



Do not speed up the defrosting process by removing the ice layer with force or sharp objects or by using a hairdryer.

13 Storage

If you do not expect to use your refrigerator for a longer period, it is important to thoroughly empty, defrost and clean the complete refrigerator.

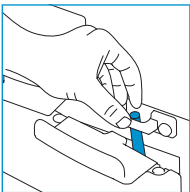

To prevent odours and mould in the refrigerator, keep all doors open during storage. Rotate the hook at door lock and lock it in place by using the strike plate, as illustrated.



Make sure the gas taps of the LP gas bottle are closed during storage.



Water through the vents may damage your refrigerator. Therefore make sure the vent openings are covered before washing your vehicle.

14 Disposal

Your refrigerator has been designed and manufactured with high quality materials and components, which can be recycled and reused. The cooling system contains ammonia as the coolant and ozone friendly cyclopentane as the blowing agent in the foam.

When your refrigerator has reached its end of life, dispose the product according to the local rules. Do not dispose the refrigerator with normal household waste. The correct disposal of your old product will help prevent potential negative consequences to the environment and human health.

15 Questions?

If you require further information or have any questions about your refrigerator, please visit our website www.thetford.com.au. If you still have questions, contact the Customer Service Department in your country (see the address on the back).

For correct and efficient support, please ensure all relevant product type information is available (see page 18).

Troubleshooting

Some problems are indicated through blinking lights on your control panel. First read the instructions below. If this will not solve the problem, contact your dealer or a Thetford Service Centre.



The refrigerator does not work

switch the refrigerator off and on again • make sure any power source is available



The refrigerator does not work on 240V

check if the mains is available • try to run the refrigerator on another power source



The refrigerator does not work on 12V

check if the 12V fuse in the fuse box of your motor home or car is still operational • make sure the engine is running • try to run the refrigerator on another power source



The refrigerator does not work on LP gas

check if the LP gas bottle is not empty • check if the valve of the LP gas bottle and all shut-off valves are open • switch the refrigerator off and on again • try to run the refrigerator on another power source.

FAQ

What can I do, when the refrigerator does not start? Check if you switched on the refrigerator according to the instructions, if the vehicle stands level or if there is an available energy source to start the refrigerator with. If none of this is the case, please contact your dealer or a Thetford Service Centre.

The refrigerator does not cool sufficiently, what can I do? Check if the vents aren't covered or blocked from the outside, if the refrigerator stands level, if the highest cooling level of the refrigerator is selected, if the ventilators are switched on, if the door of the refrigerator still closes properly or if there is not too much ice on the cooling fins. If none of this is the case, please contact your dealer or a Thetford Service Centre.

All lights on the control panel are blinking, what should I do? Switch the refrigerator off and on again. If this doesn't help, please contact your dealer or a Thetford Service Centre.

Spare parts

Original Thetford spare parts are available through your own dealer or an authorised Thetford Service Centre.

16 Warranty

Thetford BV offers the end users of its products a three-year guarantee. In the case of malfunction within the warranty period, Thetford will replace or repair the product at its discretion. In this case, the costs of replacement, labour costs for the replacement of defective components and/or the costs of the parts themselves will be paid by Thetford.

1. To make a claim under this guarantee, the user must take the product to his dealer or an authorised Thetford Service Centre (www.thetford.com.au). The claim will be assessed there.

2. Components replaced during repair under guarantee become the property of Thetford.

3. This warranty does not prejudice current consumer protection laws.

4. This warranty is not valid in the case of products that are for, or are used for, commercial purposes.

5. Guarantee claims falling into one of the following categories will not be accepted:

- the product has been improperly used, or the instructions in the manual have not been followed;
- the product has not been installed in accordance with the instructions;
- alterations have been made to the product;
- the product has been repaired by an unauthorised Thetford Service Centre;
- the product code or serial ID has been changed;
- the product has been damaged by circumstances outside the normal use of the product.

6. The guarantee is only valid for Thetford refrigerators that are built in in a caravan or motorhome.

Thetford is not liable for any loss and/or damage caused directly or indirectly by use of the refrigerator.

Thetford is not responsible for printing errors and reserves the right to make changes to product specifications without notice.

INSTRUCTIONS FOR USE

N3185A with touchscreen

Gross volume: 177L

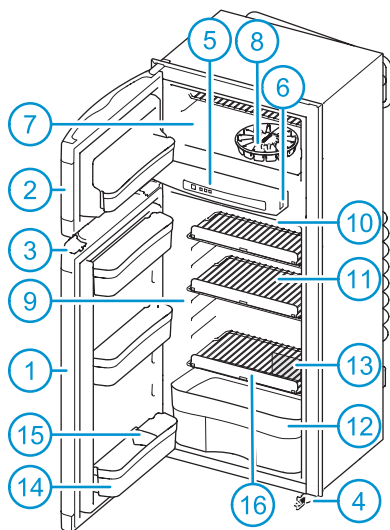

Control panel with touchscreen

(N3185E+ with LED control panel → p. 4)

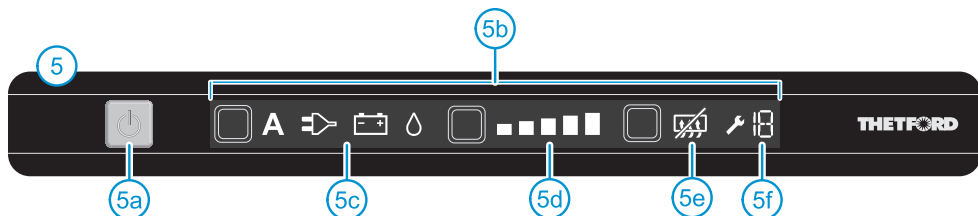

Main parts

- 1 Refrigerator door
- 2 Freezer door
- 3 Door lock
- 4 Security lock
- 5 Control panel with LCD touchscreen
- 5a On/off switch
- 5b Touchscreen
- 5c Sources
- 5d Cooling level indicators
- 5e 'Anti-condensation'
- 5f Error code
- 6 Switch for fans
- 7 Freezer compartment
- 8 Ice cube tray
- 9 Refrigerator compartment
- 10 Cooling fins
- 11 Storage shelf
- 12 Vegetable bin
- 13 Serial label
- 14 Door bin
- 15 Bottle retainer
- 16 Shelf food retainer

1 Introduction

This Thetford appliance is specially developed for caravans and motorhomes. It is user-friendly, meets high quality standards and gives you every possible convenience during holidays and short trips. We advise you to read the manual before using this appliance. Not all sections of this manual are relevant for all appliances. Make sure you completely read the parts of the manual that are relevant for your appliance. Keep this manual in a safe place for future reference.

For the latest version of the manual please visit www.thetford.com.au

Symbols used



Caution (possible risk of injury or product damage).



Attention. Important information.

2 Use safely

For correct and safe use of this refrigerator, you need to observe several precautions and general recommendations. If these instructions have not been followed, warranty claims will not be accepted.



What to do if you smell Liquefied Petroleum gas (LP gas): Directly close the valve of the LP gas bottle, extinguish any naked flames, do not switch on any electrical devices or lighting, open the windows and leave the room. Then contact the Customer Service Department in your country or holiday location.



What to do if you smell a pungent odour from the cooling system: Switch off the refrigerator, extinguish any naked flames, provide sufficient ventilation through vents, windows and doors. Then contact the Customer Service Department in your country or holiday location.



This appliance can be used by children aged from 8 years and above and persons with reduced physical, sensory or mental capabilities or lack of experience and knowledge if they have been given supervision or instruction concerning use of the appliance in a safe way and understand the hazards involved.



Do not allow children to play with or hide in the appliance. Children can become trapped and possibly suffocate. Do not allow children to clean or perform maintenance on the appliance without supervision.



The storage of flammable materials behind or around the refrigerator creates a fire hazard. Do not use the area behind the refrigerator to store anything, especially flammable materials (gasoline, cleaning supplies, etc).



Do not spray liquids near electrical outlets, connections or the refrigerator components. Many liquids are electrically conductive and can cause a shock hazard, electrical shorts and in some cases fire.



At regular intervals, make sure that the refrigerator flue, the burner, the vent areas and the ventilation air pathway between the vents are completely free from any flammable material or blockage. After a period of storage, it is especially important to check these areas for any flammable material or blockage caused by animals.



Do not store or use gasoline or other flammable vapors and liquid in the vicinity of this or any other appliance.

Maintenance

- Make sure that installation, electrical connection, maintenance and periodical inspection of the LP gas system will be done by a qualified technical person, according to Thetford's instructions (www.thetford.com.au) and local safety rules;
- Never open or damage the cooling system at the back of your refrigerator. The cooling system is pressurised and contains substances that can be harmful to your health;
- Never attempt to repair parts of the LP gas system, the LP gas flue or electrical components by yourself. The repairs may only be done by a qualified technician. Please contact the Customer Service Department for further support and addresses;
- Before carrying out any kind of maintenance or cleaning on your refrigerator switch off your refrigerator and disconnect both the AC and DC power sources;
- Never expose the refrigerator to rain;
- The LP gas burner must be inspected and cleaned at least once a year.

Use of LP gas

- The refrigerator is designed to run on LP gas. It does not run on natural gas or coal gas;
- Only use gas which is mentioned on the serial label inside the refrigerator;
- Make sure the type and position of the LP gas bottle meets the latest technical regulations;
- Change the LP gas bottle in open air and out of reach of any possible source of ignition;
- Never obstruct the ventilation openings in the LP gas bottle storage location;
- Keep flammable material away from the refrigerator;
- Do not use LP gas to power your refrigerator in the vicinity of petrol stations.

Food

- Respect the expiry date printed on the packaging of food;
- Defrosting, cleaning or maintenance of the refrigerator can shorten the preservability of food.

Medications

As the constant regulation of temperature can not be guaranteed, the refrigerator might not be suitable for proper storage of medications. Refer to the instructions included with the medications.

3 Switch on refrigerator

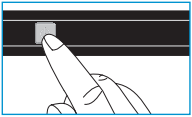

To switch on the refrigerator, push the on/off switch and hold it for 1 second, as illustrated. A light in the on/off switch will turn green.

After 10 seconds the settings will dim. The green light indicates the refrigerator is still in function.

To check the settings push the on/off switch. The last selected settings will light up.



To secure optimal performance, level your vehicle before operating the refrigerator.



For optimal performance, switch on the refrigerator 8 hours before placing food.



We advise to clean the inside of the refrigerator properly, before using your refrigerator.

4 Selecting source

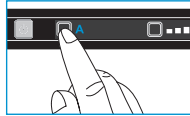

After switching on the refrigerator, push the source button several times, as illustrated. Push until the desired source is selected.

Sources



Auto

The refrigerator automatically select the best source available (in order: mains, battery, gas)



230V

The refrigerator is powered from the mains.



12V

The refrigerator is powered from the battery of your vehicle.



Gas

The refrigerator is powered from the gas connection of a gas bottle.

Always use the gas connection or mains voltage to start up and cool. Operating on 12V is only effective while the engine of the vehicle is running.

Auto

If you set the refrigerator on the automatic source selection, the control panel will show two source symbols; the A and the best source available.

It is possible to override the automatic source selection by selecting one of the energy sources manually.

240V

Make sure 240V AC is available when selecting this energy source.

12V

Make sure 12V DC is available when selecting this energy source.

The performance of the refrigerator, when operating on 12V, is dependent on the thickness and length of the wiring and the overall installation of the vehicle.



In case the refrigerator is installed in a caravan, the refrigerator needs a D+ signal (engine running) from the towing vehicle to operate in DC mode while travelling.

LP gas

Make sure the LP gas bottle valve is opened, when selecting this energy source. If the refrigerator is powered by a gas connection, make sure the control panel is powered from the battery.

When selecting LP gas, the flame should be ignited within 30 seconds. If the system fails, restart the refrigerator and select the LP gas source again.

For safety reasons it is not possible to ignite the flame within 15 minutes after driving.

From about 1000 m above sea level problems of a physical nature can occur when lighting the LP gas. This does not mean that the refrigerator is not working properly.

5 Selecting cooling level

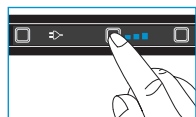

After switching on the refrigerator, push the cooling level button several times, as illustrated. Push until the desired level is selected.

Lowest cooling level  Highest cooling level



The refrigerator has climate class T.

We advise to set the refrigerator on cooling level 3, with an ambient temperature between 15°C and 25°C.

A higher temperature needs a higher cooling level, a lower temperature a lower level.

Fans

There are two fans at the rear of the refrigerator to improve the cooling performance of your refrigerator in high temperatures. It helps to detract the warm air quicker to the vents.

To switch on 1 fan (at ambient temperatures above 32°C), push the ventilator switch to '1'. For activating 2 fans (at ambient temperatures above 38°C), switch to '2', as illustrated. To switch off the fans, push the fan switch back to '0'.

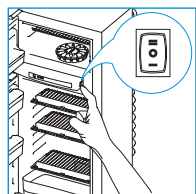

6 Anti condensation

To prevent parts from condensation, the anti-condensation function is automatically switched on. Only switch off this function when little energy is present.

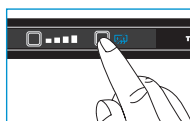

Push on the anti-condensation button. The symbol on the control panel will light up.

7 Use of refrigerator compartment

You can organise your refrigerator as desired by moving the storage shelves and door bins in height.



Make sure the door can still be closed after reorganising shelves and bins.

Moving storage shelves

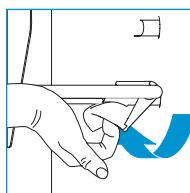

First remove the screw below the plastic clamp of the storage shelf. Then turn the plastic clamp upwards, as illustrated. Lift that side a bit, and move the storage shelf to the desired position.

First place the side of the storage shelf without the plastic clamp in the refrigerator wall, then the other side in the corresponding groove. Turn the plastic clamp downwards and replace the screw underneath. Your storage shelf is secured again.

Moving door bins

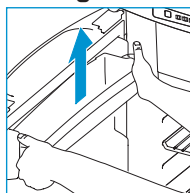



Push a door bin out of the locking with both hands, as illustrated. Place this door bin back in the desired position and push it back on the locking. The door bin is secured again.

Organising food

After a minimum of 8 hours of cooling, the food can be placed in the refrigerator. Do not completely cover the cooling fins with food, to preserve an optimal performance of the refrigerator. Make sure air can still circulate around the fins.

 To prevent your refrigerator from ice-formation, always cover liquid products, let warm products cool down before placing them in the refrigerator and don't open the door any longer than necessary.

 To reduce the cooling time, store only pre-cooled food in the refrigerator.

 To prevent the food from drying out or your refrigerator from odours, store food separately in closed boxes.

8 Use of freezer compartment

You can use the freezer compartment to keep food frozen or to make ice cubes with the included Thetford ice cube tray.

 Never keep carbonated liquids in the freezer compartment.

 If the refrigerator has to perform for a longer period in internal vehicle temperature below 10°C, a constant regulation of temperature in the freezer compartment can't be guaranteed. The temperature can increase and the food may defrost in the freezer compartment.

Making ice-cubes

Fill 2/3 of the ice-cube tray with water and put the tray in the freezer compartment. Make sure you only use drinking water.

 Never eat ice-cubes or popsicles directly out of the freezer compartment. This can cause burns.

 To speed up the process, make ice-cubes at night, when the refrigerator has more capacity. Place the ice-cube tray in an empty freezer on the bottom and the back.

9 While driving

Do not operate your refrigerator on LP gas while driving. This can reduce performance, cause an unstable flame or extinguish the flame.

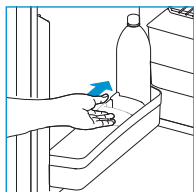

Make sure all products in your refrigerator can't move. Secure the bottles in the door with the bottle retainer and secure all food on the storage shelves with the shelf food retainers.

Door lock

When you close and press the door of the refrigerator, the door locks automatically. While driving this door lock also secures the door.

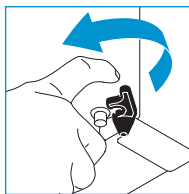



The refrigerator has an extra security lock on the bottom of the refrigerator. To be sure the door will not open while driving, push the black security lock over the pin on the door.

10 Cleaning

It is important to regularly clean the refrigerator for optimal performance. Clean the inside with a soft cloth and a mild household cleaner. Use a wet, soft cloth for the outside of the refrigerator. Make sure the vents on the outside of the vehicle are always dust-tight.

 Never clean your refrigerator with soap or aggressive, caustic or soda-based cleaning agents.

 The loose parts of the refrigerator are not suitable for the dishwasher.

 Water through the vents may damage your refrigerator.

11 Switch off refrigerator



Before defrosting the refrigerator or storing your vehicle, switch off the refrigerator. Push the on/off switch, as illustrated,

and hold it for 2 seconds to switch off the refrigerator. All lights will go out.

12 Defrosting

A layer of ice on the cooling fins will decrease the cooling capacity and durability of your refrigerator. Therefore your refrigerator is provided with an automatic defrost system, which prevents ice formation.

Despite this system, it is also possible to manually defrost your refrigerator on occasion. Remove all food, wrap it tightly in newspaper and put it in a cold place or in an insulated bag. Then open the doors. Put dry towels in the refrigerator to catch the remaining water. When the refrigerator is defrosted, thoroughly dry the inside.

 Do not speed up the defrosting process by removing the ice layer with force or sharp objects or by using a hairdryer.

13 Storage

If you do not expect to use your refrigerator for a longer period, it is important to thoroughly empty, defrost and clean the complete refrigerator.

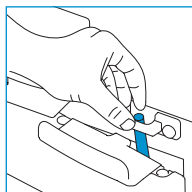

To prevent odours and mould in the refrigerator, keep all doors open during storage. Rotate the hook at door lock and lock it in place by using the strike plate, as illustrated.

 Make sure the gas taps of the gas bottle are closed during storage.

 Water through the vents may damage your refrigerator. Therefore install winter covers before washing your vehicle.

14 Disposal

Your refrigerator has been designed and manufactured with high quality materials and components, which can be recycled and reused. The cooling system contains ammonia as the coolant and ozone friendly cyclopentane as the blowing agent in the foam.

When your refrigerator has reached its end of life, dispose the product according to the local rules. Do not dispose the refrigerator with normal household waste. The correct disposal of your old product will help prevent potential negative consequences to the environment and human health.

15 Questions?

If you require further information or have any questions about your refrigerator, please visit our website www.thetford-europe.com. If you still have questions, contact the Customer Service Department in your country or your holiday location (see the addresses on the back).

For correct and efficient support, please ensure all relevant product type information is available (see page 18).

Troubleshooting

In case of a problem an error code on the control panel can light up. When error codes 1, 2, 4, 5, 8, 9, 12 or 13 are visible, switch the refrigerator off and on again. If the problems still exist, directly contact your dealer or a Thetford Service Centre.

For underneath error codes, first read the according instructions. If this will not solve the problem, contact your dealer or a Thetford Service Centre.

 **3** **The refrigerator does not work on gas:** check if the gas bottle is not empty • check if the valve of the gas bottle and all shut-off valves are open • switch the refrigerator off and on again • try to run the refrigerator on another power source

 **6** **The refrigerator does not work on 12V:** make sure the engine is running • try to run the refrigerator on another power source

 **7** **The refrigerator does not work on 12V:** make sure the engine is running • try to run the refrigerator on another power source

 **10** **The refrigerator does not work on 230V:** check if the mains is available • try to run the refrigerator on another power source

 **11** **The refrigerator does not work in AUTO mode:** check if the sources are connected • try to run the refrigerator manually on a power source

 **18** **All symbols on the control panel light up:** wait a few seconds until the refrigerator starts normal.

FAQ

What can I do, when the refrigerator does not start? Check if you switched on the refrigerator according to the instructions, if the vehicle stands level or if there is an available energy source to start the refrigerator with. If none of this is the case, please contact your dealer or a Thetford Service Centre.

The refrigerator does not cool sufficiently, what can I do? Check if the vents aren't covered or blocked from the outside and remove the mosquito screen if present. Check if the refrigerator stands level, if the highest cooling level of the refrigerator is selected, if the door of the refrigerator still closes properly or if there is not too much ice on the cooling fins. If none of this is the case, please contact your dealer or a Thetford Service Centre.

All lights on the control panel are blinking, what should I do? Switch the refrigerator off and on again. If the problem still exists, please contact your dealer or a Thetford Service Centre.

No winter cover is supplied with my refrigerator, is this correct? The winter cover is an accessory for your refrigerator, which you can purchase at your dealer.

Spare parts

Original Thetford spare parts are available through your own dealer or an authorised Thetford Service Centre.

16 Warranty

Thetford BV offers the end users of its products a three-year guarantee. In the case of malfunction within the warranty period, Thetford will replace or repair the product at its discretion. In this case, the costs of replacement, labour costs for the replacement of defective components and/or the costs of the parts themselves will be paid by Thetford.

1. To make a claim under this guarantee, the user must take the product to his dealer or an authorised Thetford Service Centre (www.thetford.com.au). The claim will be assessed there.
2. Components replaced during repair under guarantee become the property of Thetford.
3. This warranty does not prejudice current consumer protection laws.
4. This warranty is not valid in the case of products that are for, or are used for, commercial purposes.
5. Guarantee claims falling into one of the following categories will not be accepted:
 - the product has been improperly used, or the instructions in the manual have not been followed;
 - the product has not been installed in accordance with the instructions;
 - alterations have been made to the product;
 - the product has been repaired by an unauthorised Thetford Service Centre;
 - the product code or serial ID has been changed;
 - the product has been damaged by circumstances outside the normal use of the product.
6. The guarantee is only valid for Thetford refrigerators that are built in in a caravan of motorhome.

Thetford is not liable for any loss and/or damage caused directly or indirectly by use of the refrigerator.

Thetford is not responsible for printing errors and reserves the right to make changes to product specifications without notice.

FOR GUARANTEE/SERVICE

For guarantee/service requests, please identify your refrigerator.

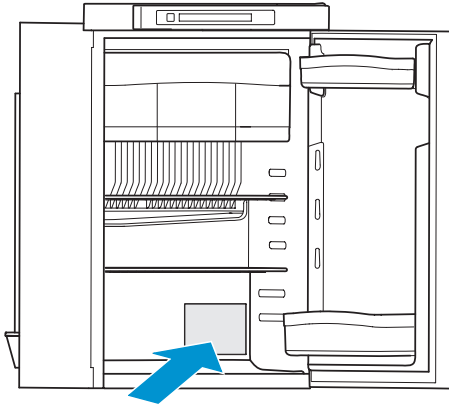

THETFORD

Model No
 Serie No

Type **C11** 0063
 Climate Class **03 2257**

240 VAC / 50 Hz / 300 W 12 VDC / 205 W IP24 101213

Gross Volume	177 L	Qn 416
		m 30,7 g
		Gas consumption 1,5 MJ/h
Certificate of compliance AGA XXXXXXXX	For universal LP gas use only Input 2,75 kPa	
	 E344P1000006	
CE 0063 / 03297	Part No 690972	
ABSORBER NH3 = 206.5 g	NA2CR04 = 13.5 g	p max = 24 bar
0020_SerialFridge_AUS		

SPECIMEN

AUSTRALIA

Thetford Australia Pty. Ltd.
41 Lara Way
Campbellfield VIC 3061
Australia

T +61 3 9358 0700
F +61 3 9357 7060
E infoau@thetford.eu
www.thetford.com.au

EUROPEAN HEADQUARTERS

Thetford B.V.
Nijverheidsweg 29
P.O. Box 169
4870 AD Etten-Leur
The Netherlands

T +31 76 504 22 00
F +31 76 504 23 00
E info@thetford.eu

UNITED KINGDOM

Thetford Ltd.
Unit 6
Brookfields Way
Manvers, Rotherham
S63 5DL, England
United Kingdom

T +44 844 997 1960
F +44 844 997 1961
E info@thetford.eu

GERMANY

Thetford GmbH
Schallbruch 14
D-42781 Haan
Deutschland

T +49 2129 94250
F +49 2129 942525
E info@thetford.eu

FRANCE

Thetford S.A.R.L.
Parc BUR0PLUS / Bâtiment 6
18, Boulevard de la Paix
CS 80008
95895 CERGY PONTOISE CEDEX
France

T +33 1 30 37 58 23
F +33 1 30 37 97 67
E info@thetford.eu

ITALY

Thetford Italy c/o Tecma s.r.l.
Via Flaminia
Loc. Castel delle Formiche
05030 Otricoli (TR)
Italia

T +39 0744 709071
F +39 0744 719833
E info@thetford.eu

SPAIN AND PORTUGAL

Mercè Grau Solà
Agente para España y Portugal
c/ Castellet, 36 bxs 2ª
08800 Vilanova i la Geltrú
Barcelona
España

T +34 938 154 389
F not available
E info@thetford.eu

SCANDINAVIA

Thetford B.V.
Representative Office
Scandinavia
Hantverkaregatan 32D
521 61 Stenstorp
Sverige

T +46 31 336 35 80
F +46 31 44 85 70
E info@thetford.eu

CHINA

Thetford China
Rm. 1207, Coastal Building (East Block)
Haide 3rd Road, Nanshan District
Shenzhen 518054
China

T +86 755 8627 1393
F +86 755 8627 1673
E info@thetford.cn
www.thetford.cn